

IMPORTANT PRECAUTIONS

When using electrical appliances, especially when children are present, it is necessary to observe basic precautions.

To avoid electric shock:

- Before cleaning the appliance, disconnect it from the mains.
- Do not use the appliance in the bath or shower, do not drop it into water or other liquids.

Do not touch an electrical appliance that has fallen into the water! Disconnect it from the network immediately.

To avoid burns, fire or injury:

- Use this appliance only for those purposes that described in this operating manual. Do not use devices that are not recommended by the manufacturer.
- Never leave this appliance plugged into the mains unattended.
- When the appliance is used by children or disabled people, careful monitoring of its operation is necessary.
- Never operate the appliance if the cord or plug is damaged.
- Keep the cord away from heated surfaces. Do not pull or bend the cord, and do not wind it on the appliance.
- Do not drop the appliance. Do not insert foreign objects into its holes.
- Before using this appliance, make sure that the knives are properly adjusted.

Warranty obligations:

1. The manufacturer guarantees the operation of the product under the conditions of transportation, storage and operation.
2. Warranty obligations apply to all types of damage to the product provably caused by a manufacturing defect.
3. The warranty does not apply to mechanical damage to the product.
4. The warranty period of the product is 12 months from the date of sale.

The warranty does not apply to:

- Products, if malfunctions in them have arisen as a result of a violation rules of operation and transportation.
- Damage caused by excessive loads, improper handling, improper storage or maintenance, improper removal of the knife.
- For components worn out during operation that have a limited service life (POWER CORDS, brushes, plastic leashes, etc.)
- Damage caused by ingestion of foreign objects, substances, insects.
- Self-repair of the product or repair carried out in non-specialized workshops.

The consumer is deprived of the rights to warranty service in the following cases:

- when the warranty period expires;
- in the presence of mechanical damage to the outer parts of the product;
- in case of violation of the rules of operation.

Cleaning, lubrication of products, sharpening of knives after any period of operation are not included in the cost of warranty service.

To perform warranty repairs, you must present documents certifying the purchase of this product, this product instruction with the signature of the seller and the seal of the trading organization.

« _____ » _____ 20__ y. « _____ » _____ 20__ y.

Seller Signature Seller Signature

place for stamp

place for stamp

KURO NEKO

IRIMI

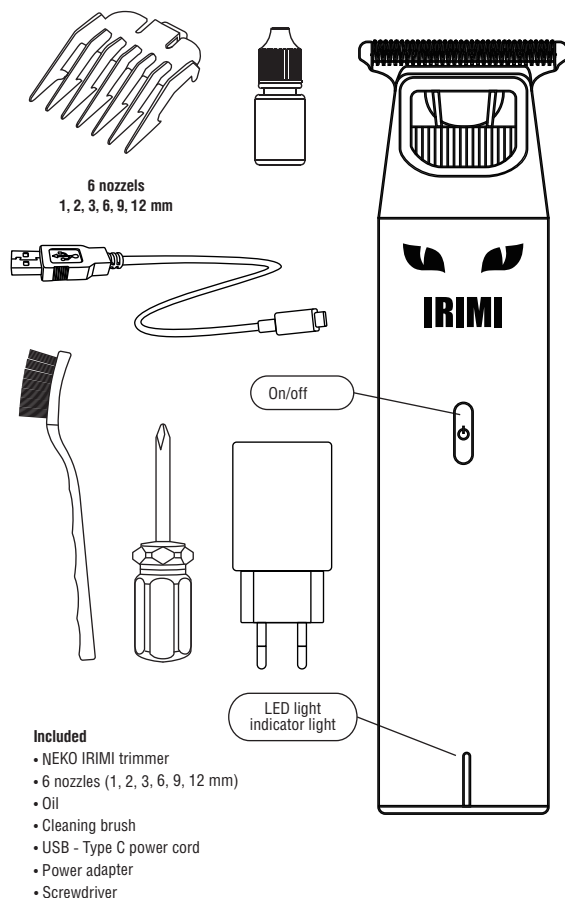

TECHNICAL SPECIFICATIONS

Hair Clipper	Motor	Working voltage: 5V Power: 7500 rpm
	Battery	Capacity: 1200 mAh Charging time: 120 min Working time: 150 min
Adapter		Input: 100-240 V, 50-60 Hz Output: 5 V, 1000 MA

OPERATING INSTRUCTIONS

Important!

The device was not charged at the factory. Please charge the device at least 3 hours before the first use to achieve maximum performance.

Charging method

1. Insert the charger into the tail of the trimmer, connect to a power source to start charging.
2. The LED indicator lights up, indicating that it is starting to charge.

Installation of comb attachments

Install a restrictive comb:

1. Align the end comb with the edge of the blade.

2. Press forward slightly to install it.

Disassemble the restrictive comb:

Just pull the limit comb with all your might



Removing the cutting head

To remove the cutting head, unscrew the screws on the underside of the blade as shown in the picture

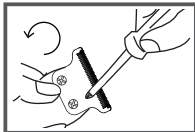

Installing the cutting head

1) To install, align the blade spring of the device (A) with the spring on the knife head (B). Then insert the two mounting screws and hold down.

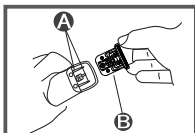

2) Tighten the screws on the underside of the blade with a screwdriver as shown in the picture.

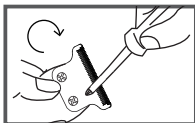

Cleaning the cutting head

Regular cleaning of the device is necessary to maintain optimal performance and maximum safety of your machine. Do not wet the typewriter and knives! Use a special brush for cleaning (included)

Clean the blades of the cutting head with a cleaning brush.

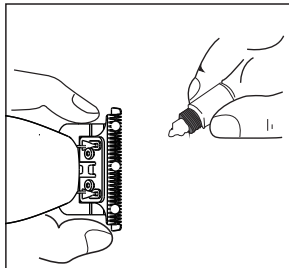
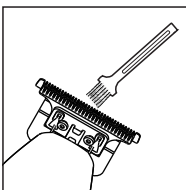

Before or after use, keep the blade clean, dripping a little oil on the places with red dots, as shown in the picture on the left.

Troubleshooting

If your hair clipper is working or charging incorrectly, please check the following:

- Check for current in the outlet by connecting another device to the outlet.
 - Make sure that the device is not connected to a power source when it turns off automatically.
 - Make sure that the contacts between the machine and the power adapter are clean and do not contain hair or other contaminants.
 - Make sure that the cutting head is installed correctly.
 - Make sure the clipper is fully charged.
1. Please do not disassemble the product.
 2. Do not use water to wash the clipper, avoid moisture during operation.
 3. Use only a little damp cloth or neutral liquid soap to clean the product.
 4. Never charge the device at temperatures above 40°C or at ambient temperatures below 0°C.
- Slight heating during operation or charging is a normal case
 - At the end of the battery life, remove and discard the battery in a safe way to a designated place for disposal. Never throw it away randomly.