

IMPORTANT PRECAUTIONS

When using electrical appliances, especially when children are present, it is necessary to observe basic precautions.

To avoid electric shock:

- Before cleaning the appliance, disconnect it from the mains.
- Do not use the appliance in the bath or shower, do not drop it into water or other liquids.

Do not touch an electrical appliance that has fallen into the water!
Disconnect it from the network immediately.

To avoid burns, fire or injury:

- Use this appliance only for those purposes that described in this operating manual. Do not use devices that are not recommended by the manufacturer.
- Never leave this appliance plugged into the mains unattended.
- When the appliance is used by children or disabled people, careful monitoring of its operation is necessary.
- Never operate the appliance if the cord or plug is damaged.
- Keep the cord away from heated surfaces. Do not pull or bend the cord, and do not wind it on the appliance.
- Do not drop the appliance. Do not insert foreign objects into its holes.
- Before using this appliance, make sure that the knives are properly adjusted.

Warranty obligations:

1. The manufacturer guarantees the operation of the product under the conditions of transportation, storage and operation.
2. Warranty obligations apply to all types of damage to the product provably caused by a manufacturing defect.
3. The warranty does not apply to mechanical damage to the product.
4. The warranty period of the product is 12 months from the date of sale.

The warranty does not apply to:

- Products, if malfunctions in them have arisen as a result of a violation rules of operation and transportation.
- Damage caused by excessive loads, improper handling, improper storage or maintenance, improper removal of the knife.
- For components worn out during operation that have a limited service life (POWER CORDS, brushes, plastic leashes, etc.)
- Damage caused by ingestion of foreign objects, substances, insects.
- Self-repair of the product or repair carried out in non-specialized workshops.

The consumer is deprived of the rights to warranty service in the following cases:

- when the warranty period expires;
- in the presence of mechanical damage to the outer parts of the product;
- in case of violation of the rules of operation.

Cleaning, lubrication of products, sharpening of knives after any period of operation are not included in the cost of warranty service.

To perform warranty repairs, you must present documents certifying the purchase of this product, this product instruction with the signature of the seller and the seal of the trading organization.

« _____ » 20 ____ г. « _____ » 20 ____ г.

Seller _____ Signature _____ Seller _____ Signature _____

place for stamp

place for stamp

KURO NEKO

AKUMA

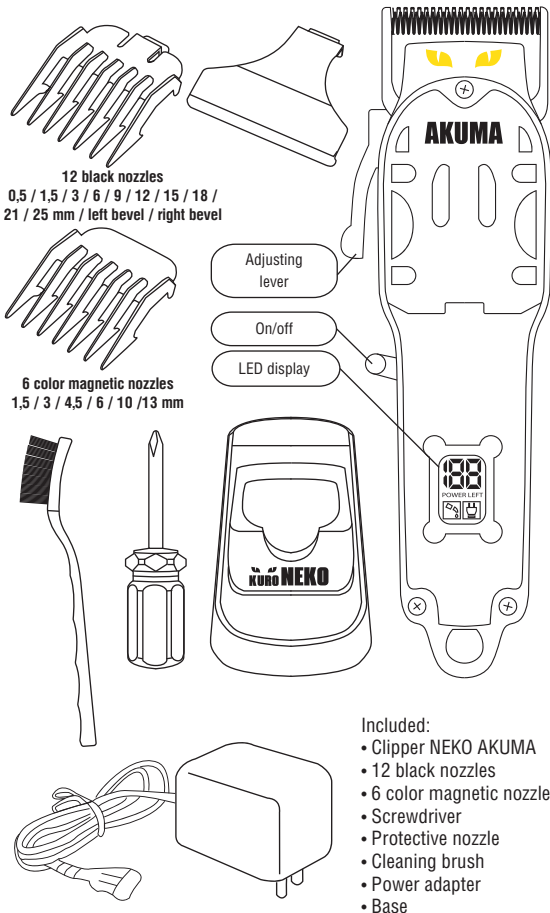

Included:

- Clipper NEKO AKUMA
- 12 black nozzles
- 6 color magnetic nozzles
- Screwdriver
- Protective nozzle
- Cleaning brush
- Power adapter
- Base

TECHNICAL SPECIFICATIONS

Hair Clipper	Motor	Working voltage: 7V Power: 7200 rpm
	Battery	Capacity: 2500 mAh Charging time: 210 min Working time: 210 min
Adapter		Input: 100-240 V, 50-60 Hz Output: 5 V, 1000 MA

OPERATING INSTRUCTIONS

Important!

The machine was not charged at the factory. Please charge the machine at least 3 hours before the first use to achieve maximum performance.

Charging method

1. Remove the typewriter and charger from the box.
2. Plug the charger into an outlet.
3. Make sure the switch is in the "OFF" position after start charging.
4. 1 TCO screen on the front panel of the machine will indicate the charge status.
5. After the battery is fully charged, remove the charger from the wall outlet.

If the machine must remain unused for a long period of time, store it in a safe, cool, dry place. Do not wrap the cord tightly around the blades. Do not hang the machine for power cord.

Setting up and caring for blades

1. To adjust the length of the blades, use the adjustment lever (Figure 1)
2. Before using the machine, apply oil to the specified places (Figure 2) to avoid overheating and wear of the blades.

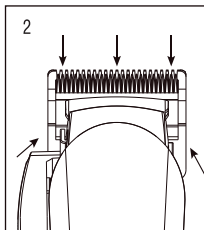
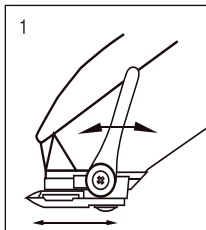

Installation of comb attachments

1. Install the nozzle on the cutting head of the shaver along the guides and press on the back side of the comb attachment until it snaps into place.
2. To remove the comb attachment, pull the tongue on the back side

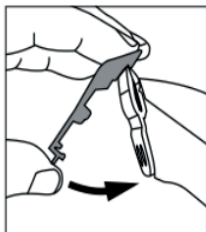

Cleaning method.

Regular cleaning of the device is necessary to maintain optimal productivity and maximum safety of your machine. Do not wet the typewriter and knives! Use a special brush for cleaning (included in the package)

Cleaning the typewriter.

Use a cleaning brush to clean the knife head. Clean the hair remaining between the upper/lower blades. Do not remove the spring of the cutting head, this may cause damage.

After cleaning, apply 1-2 drops of oil to the cutting head as shown above. After leveling the cutting knives, you should hear a "click", which indicates that the blades are installed correctly.

Troubleshooting

If your hair clipper is working or charging incorrectly, please check the following:

- Check for current in the outlet by connecting another device to the outlet.
- Make sure that the device is not connected to a power source when it turns off automatically.
- Make sure that the contacts between the machine and the power adapter are clean and do not contain hair or other contaminants.
- Make sure that the cutting head is installed correctly.
- Make sure the clipper is fully charged.